

PLAN

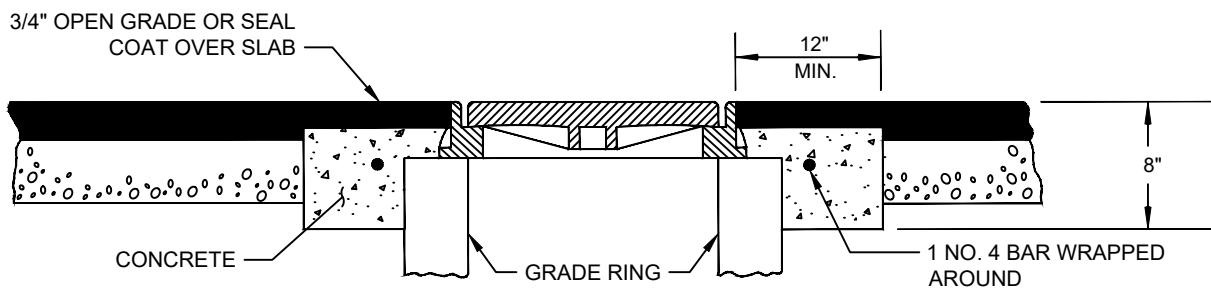

SECTION A-A

NOTES

1. CONCRETE COLLAR TO BE CONSTRUCTED 1/8" BELOW SURFACE OF DENSE GRADE WHERE OPEN GRADE IS NOT USED.
2. CONCRETE COLLAR NOT REQUIRED IN UNINCORPORATED CLARK COUNTY RESIDENTIAL STREETS LESS THAN 80' R/W WIDTH.
3. WHEN INSTALLED WITHIN PEDESTRIAN ACCESS ROUTES, TOP OF MANHOLE COVERS SHALL HAVE NO VERTICAL SURFACE DISCONTINUITIES GREATER THAN 1/4" WITH ADJACENT SURFACE, HAVE NO GAPS GREATER THAN 1/2" REGARDLESS OF CONSTRUCTION TOLERANCES, AND BE FIRM, STABLE, AND SLIP RESISTANT.

AGENCY APPROVED    B        H    L    M    N    R

SPECIFICATION REFERENCE

501	CONCRETE
505	REINFORCING STEEL

UNIFORM STANDARD DRAWINGS  
CLARK COUNTY AREA

CONCRETE COLLAR AROUND  
MANHOLES

DATE 01-09-20    DWG. NO. 408