

1" DIA. VENT HOLE

COVER

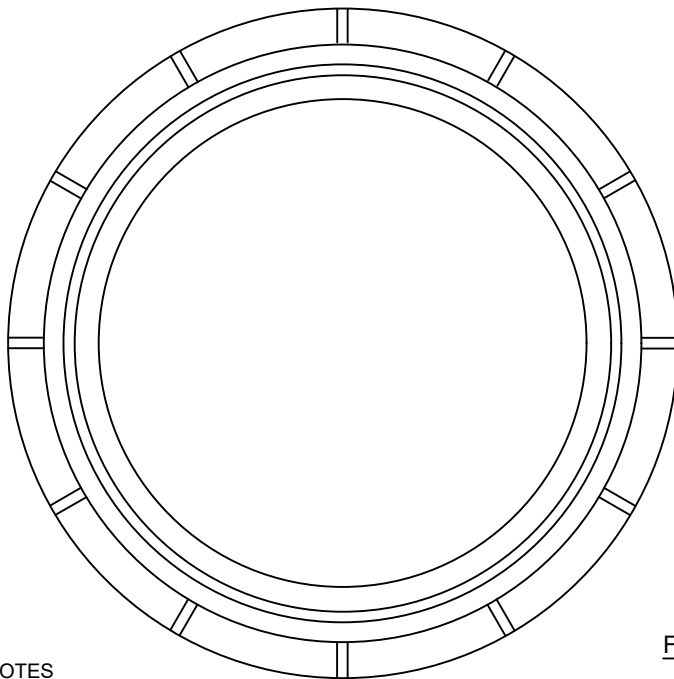

FRAME

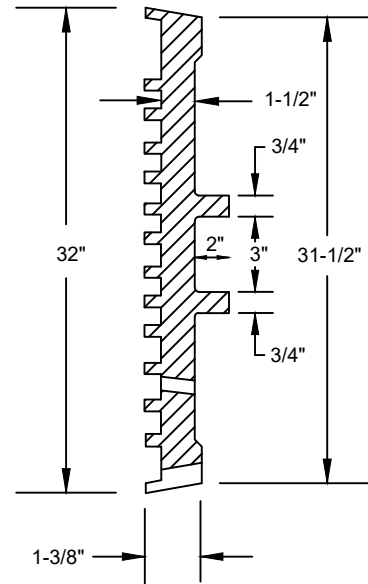
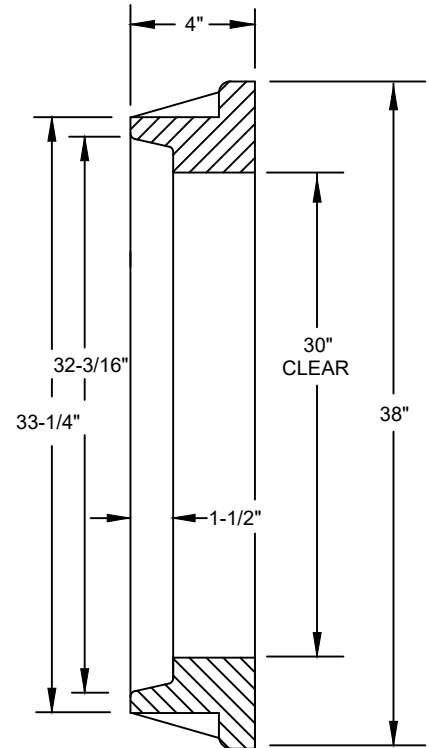

NOTES

1. FRAME AND COVER TO BE ALHAMBRA FOUNDRY COMPANY TYPE A1252B IN ACCORDANCE WITH ASTM A-48, CLASS 30, OR APPROVED EQUAL.
2. CAST IRON SHALL HAVE MINIMUM TENSILE STRENGTH OF 30,000 P.S.I.
3. FRAME AND COVER MACHINED TO FIT.
4. WEIGHT OF FRAME AND COVER 330 LBS. MINIMUM.
5. THE USE OF A 30" RING AND COVER SHALL BE APPROVED BY THE ENTITY ENGINEER.

AGENCY APPROVED	B	C	H	L	M	N	R
-----------------	---	---	---	---	---	---	---

SPECIFICATION REFERENCE	
712	MISCELLANEOUS METALS

UNIFORM STANDARD DRAWINGS
CLARK COUNTY AREA

STANDARD MANHOLE
30 INCH COVER AND RING

DATE 10/08/20	DWG. NO. 409.1
---------------	----------------