

**UNIFORM STANDARD DRAWINGS
CLARK COUNTY AREA
VOLUME I - YEAR 2011 REVISIONS**

DRAWING NUMBER	TITLE AND REVISION SUMMARY	EFFECTIVE DATE
221.1	“Channelized Median Detail for Commercial Dirveways or Intersecting Streets” - Revision to remove “ONLY” symbol from dedicated turn lanes.	07/01/11
234.3	“Bus Stop Placement Within Exclusive Right Turn Lane for Commercial Properties” - Revision to remove “ONLY” symbol from dedicated turn lanes.	07/01/11
246	“Standard Pavement Markers Added Turn Lane” - Revision to remove “ONLY” symbol from dedicated turn lanes.	07/01/11
246B	“Pavement Marking and Signage Right Turn Lane at Minor Intersections (Arterials With Emergency/Parking Lane)” - Revision to remove “ONLY” symbol from dedicated turn lanes.	07/01/11
246.1	“Bicycle Lane Approach to Intersection With Exclusive Right Turn Lane” - Revision to remove “ONLY” symbol from dedicated turn lanes.	07/01/11
246.2	“Bicycle Lane Transition to Shared Lane at Intersection” - Revision to remove “ONLY” symbol from dedicated turn lanes.	07/01/11
421	Storm Water Quality Management Stamp and Sign Detail” – New standard drawing to require marking of storm drain inlets.	01/01/11
506	"Utility Pothole Repair" – New standard drawing to allow for keyhole type pothole excavation and repair.	01/01/11
ALL	General re-formatting revisions to the Uniform Standard Drawings, Volume I and Volume II, to accommodate supplemental drawings and <i>consolidate the drawings into one document.</i>	07/01/11

4' PCC MEDIAN STRIP PER
STD. DWG. NO. 218
(TYP.)

2' CURB FACE
TO CURB FACE
(TYP.)

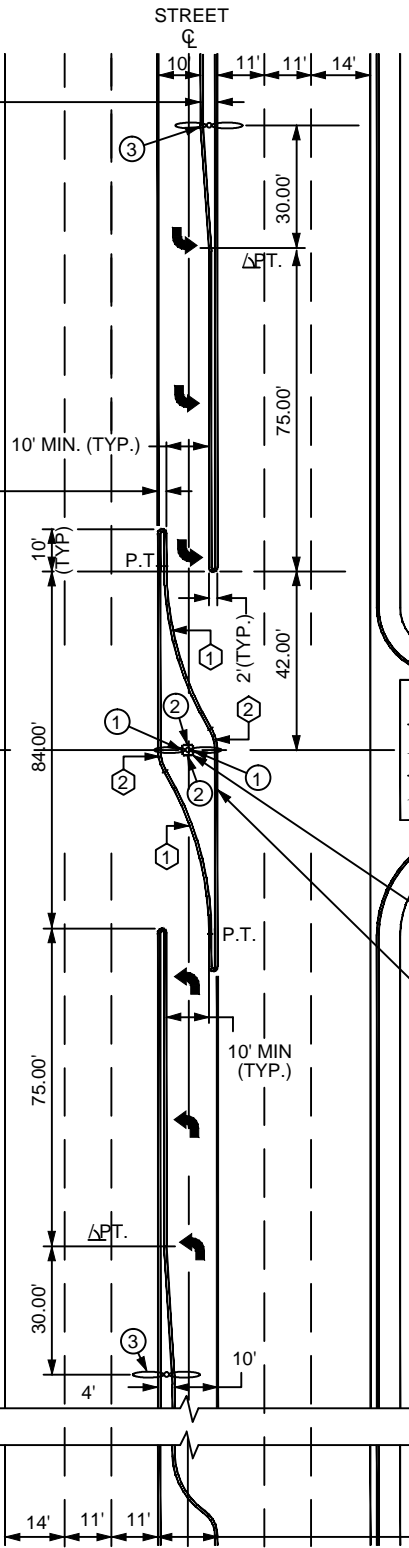

CURVE DATA

①	②
Δ = 74.00'	Δ = 10.00'
R = 74.00'	R = 10.00'
T = 20.52'	T = 2.77'
L = 40.04'	L = 5.41'

LOCATE ST. LT.
CENTERED IN
MEDIAN ③

PCC ISLAND CURB PER
STD. DWG. NO. 220
(TYP.)

NOTES:

- ① INSTALL R5-1
- ② INSTALL R3-2
- ③ STREETLIGHT LOCATION
STANDARD FOR THE CITY OF
HENDERSON OR IF SPECIFIED
BY THE ENGINEER.
- ④ DETAIL MAY BE USED FOR
INTERSECTIONS OF STREETS
WITH R/W 60 FEET OR LESS
IF APPROVED BY THE
ENTITY ENGINEER. SPECIAL
MEDIAN DESIGN IS REQUIRED
FOR INTERSECTING STREETS
WITH R/W GREATER THAN
60 FEET.

14' MEDIAN WIDTH, CURB FACE TO CURB
FACE (TYP.) PER STD DWG #218

SPECIFICATION REFERENCE		AGENCY APPROVED					
		B	C	①	L	M	N
		UNIFORM STANDARD DRAWINGS CLARK COUNTY AREA					
		CHANNELIZED MEDIAN DETAIL FOR COMMERCIAL DRIVEWAYS OR INTERSECTING STREETS					
		DATE	6-9-11	DWG. NO.	221		

COMMERCIAL DRIVEWAY
INTO PROPERTY

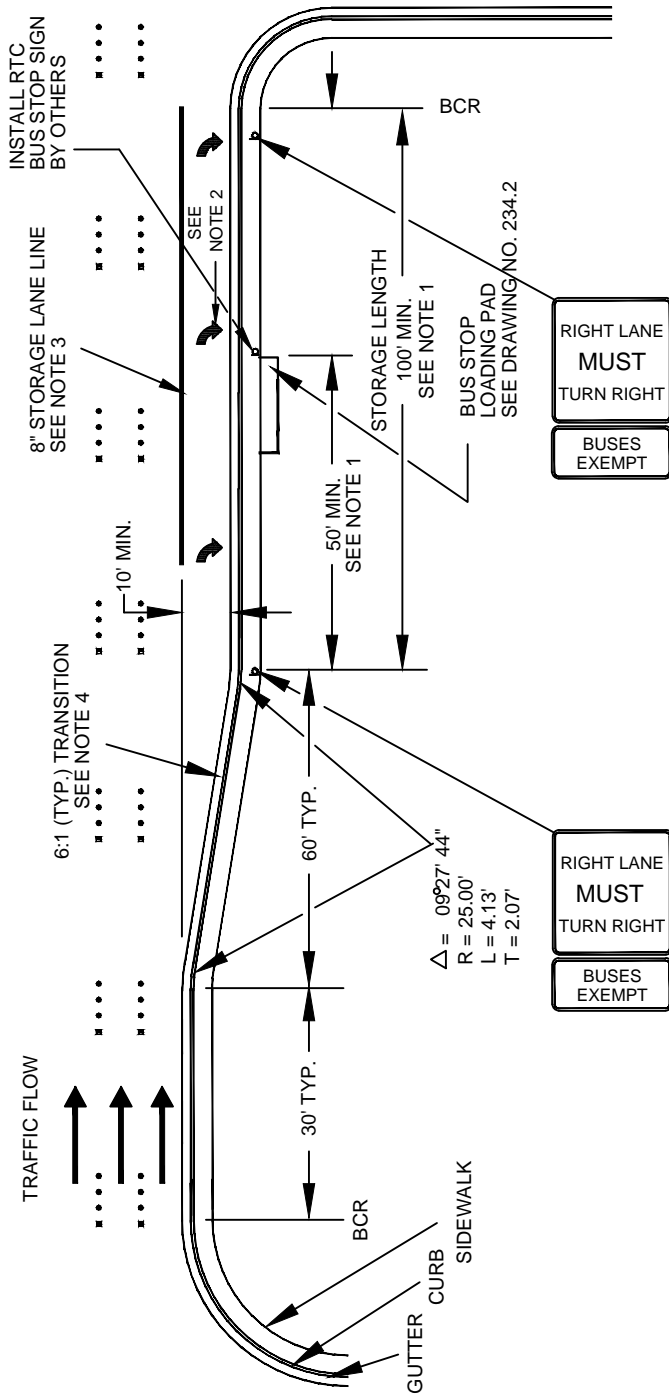

NOTES:

1. IF ARTICULATED BUSES ARE EXPECTED TO SERVICE BUS STOP, DISTANCE FROM END OF ENTRY TAPER TO THE END OF THE BUS STOP LOADING PAD SHALL BE INCREASED TO 70 FT. MIN. AND THE RIGHT TURN STORAGE LANE LENGTH SHALL BE INCREASED TO 120 FT. MIN.
2. WHERE ADDITIONAL MOTORIST GUIDANCE IS DEEMED NECESSARY BY THE ENGINEER, INSTALL ARROW AND "ONLY" SYMBOL PAVEMENT MARKINGS FOR THE LENGTH OF THE STORAGE LANE. SYMBOLS SHALL BE APPROVED TYPE II PAVEMENT MARKING FILM.
3. STORAGE LANE LINE SHALL BE APPROVED TYPE I PAVEMENT MARKING FILM, OR IF APPROVED BY THE ENGINEER, RAISED PAVEMENT MARKERS MAY BE USED.
4. REVERSE CURVE TRANSITION MAY BE USED SUBJECT TO THE APPROVAL OF THE ENGINEER.

AGENCY APPROVED		B	C	H	L	M	N
SPECIFICATION REFERENCE		UNIFORM STANDARD DRAWINGS CLARK COUNTY AREA					
302	AGGREGATE BASE	BUS STOP PLACEMENT WITHIN EXCLUSIVE RIGHT TURN LANE FOR COMMERCIAL PROPERTIES					
501	CONCRETE						
502	CONCRETE STRUCTURES						
628	PAINTING TRAFFIC STRIPING, PAVEMENT MARKINGS...						
DATE	06-09-11	DWG. NO.	234.4				

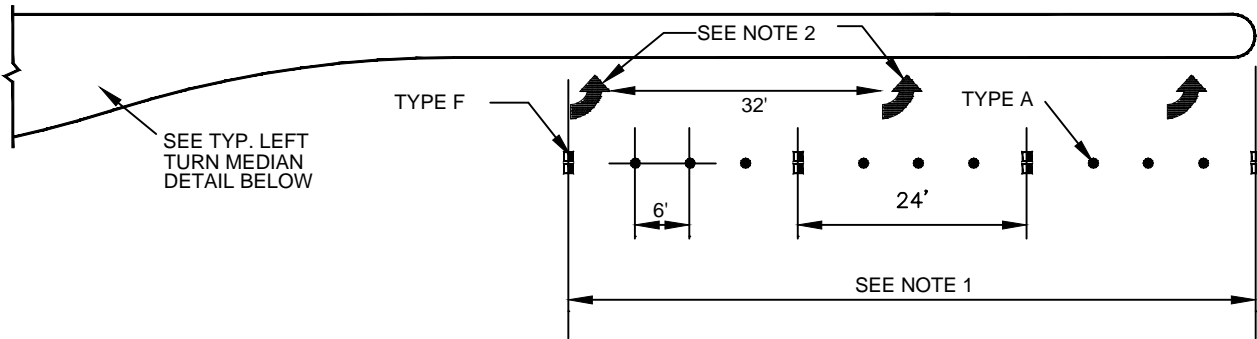

ADDED LEFT TURN LANE

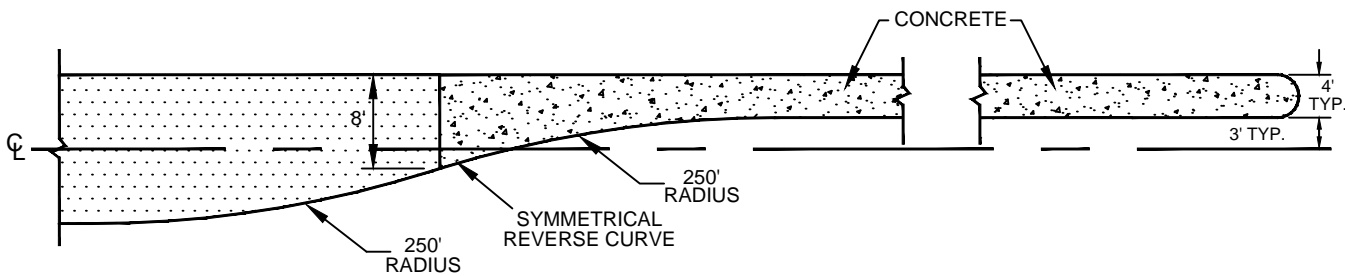

TYPICAL LEFT TURN MEDIAN DETAIL

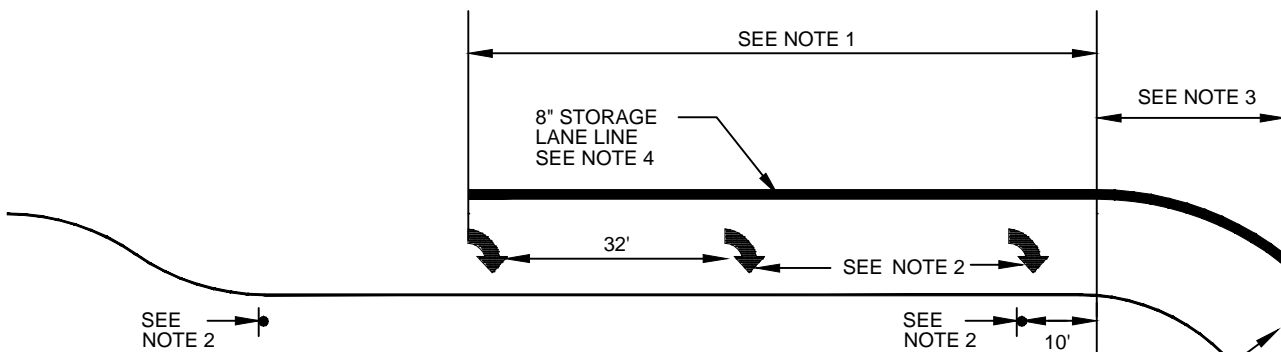

ADDED RIGHT TURN LANE

NOTES:

1. LENGTH OF STORAGE LINE IS TWO THIRDS OF THE ADDED TURN BAY. (MIN. 100')
2. WHERE ADDITIONAL MOTORIST GUIDANCE IS DEEMED NECESSARY BY THE ENGINEER, INSTALL R3-7R SIGN AND ARROW SYMBOL PAVEMENT MARKINGS FOR THE LENGTH OF THE STORAGE LINE. SYMBOLS SHALL BE APPROVED TYPE II PAVEMENT MARKING FILM.
3. APPROVED TYPE II PAVEMENT MARKING FILM OR RAISED PAVEMENT MARKERS MAY BE USED FOR ADDITIONAL GUIDANCE AT THE DISCRETION OF THE ENGINEER.
4. STORAGE LANE LINE SHALL BE APPROVED TYPE I PAVEMENT MARKING FILM OR IF APPROVED BY THE ENGINEER, RAISED PAVEMENT MARKERS MAY BE USED.

		AGENCY APPROVED	B	C	H	L	M	N
SPECIFICATION REFERENCE		UNIFORM STANDARD DRAWINGS CLARK COUNTY AREA						
633	PAVEMENT MARKERS	STANDARD PAVEMENT MARKERS ADDED TURN LANE						
628	PAINTING TRAFFIC STRIPING, PAVEMENT MARKINGS...							
		DATE 06-09-11	DWG. NO.		246			

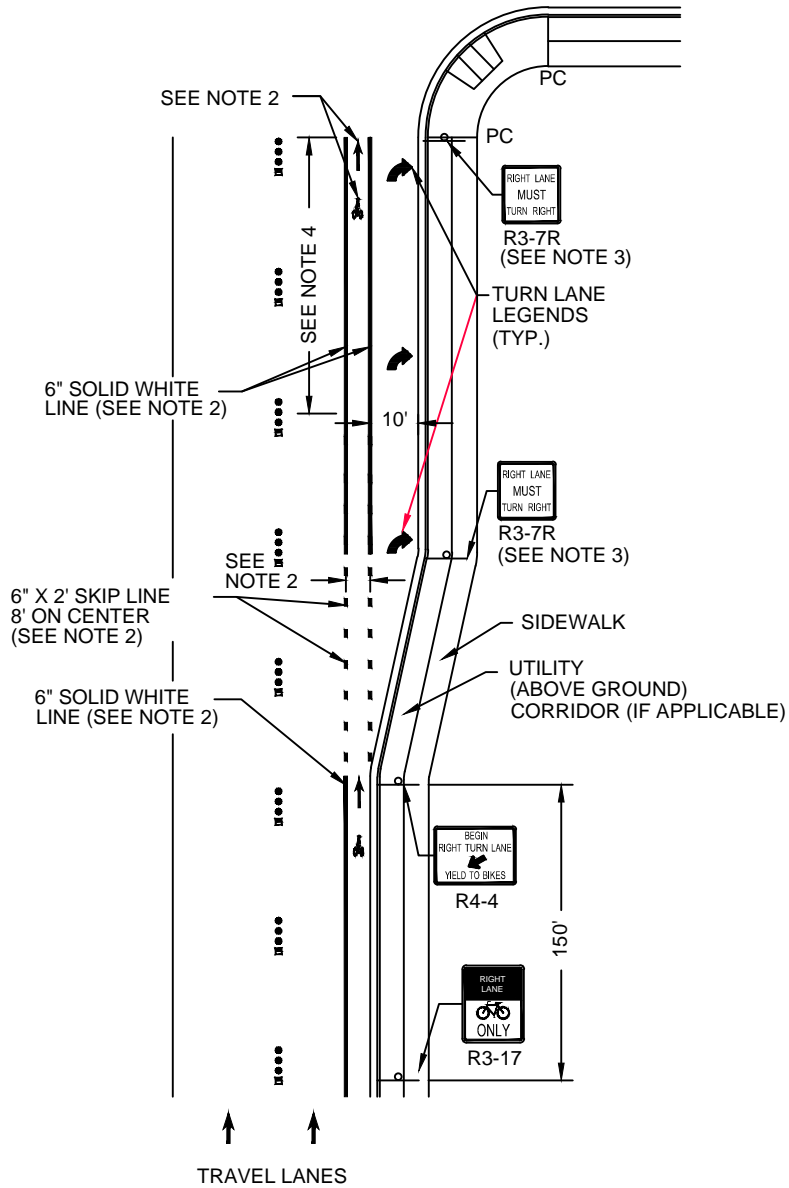

NOTES:

1. STORAGE LENGTH TO BE DETERMINED BY TRAFFIC ENGINEER.
2. SEE DRAWING NO. 244.9 FOR BIKE LANE LEGEND AND SIGNAGE.
3. WHERE ADDITIONAL MOTORIST GUIDANCE IS DEEMED NECESSARY BY THE TRAFFIC ENGINEER, INSTALL R3-7R SIGN AND ARROW SYMBOL PAVEMENT MARKINGS FOR THE LENGTH OF THE STORAGE LINE. APPROVED TYPE II PAVEMENT MARKING FILM SHALL BE USED FOR SYMBOL MARKINGS.
4. SEE DRAWING NO. 246 NOTE 1 FOR STANDARD PAVEMENT MARKERS ADDED TURN LANE.

		AGENCY APPROVED	B	C	H	L	M	N
SPECIFICATION REFERENCE		UNIFORM STANDARD DRAWINGS CLARK COUNTY AREA						
628	PAINTING TRAFFIC STRIPING	BICYCLE LANE APPROACH TO INTERSECTION WITH EXCLUSIVE RIGHT TURN LANE						
633	PAVEMENT MARKERS							
DATE 06-09-11		DWG. NO.		246.1				

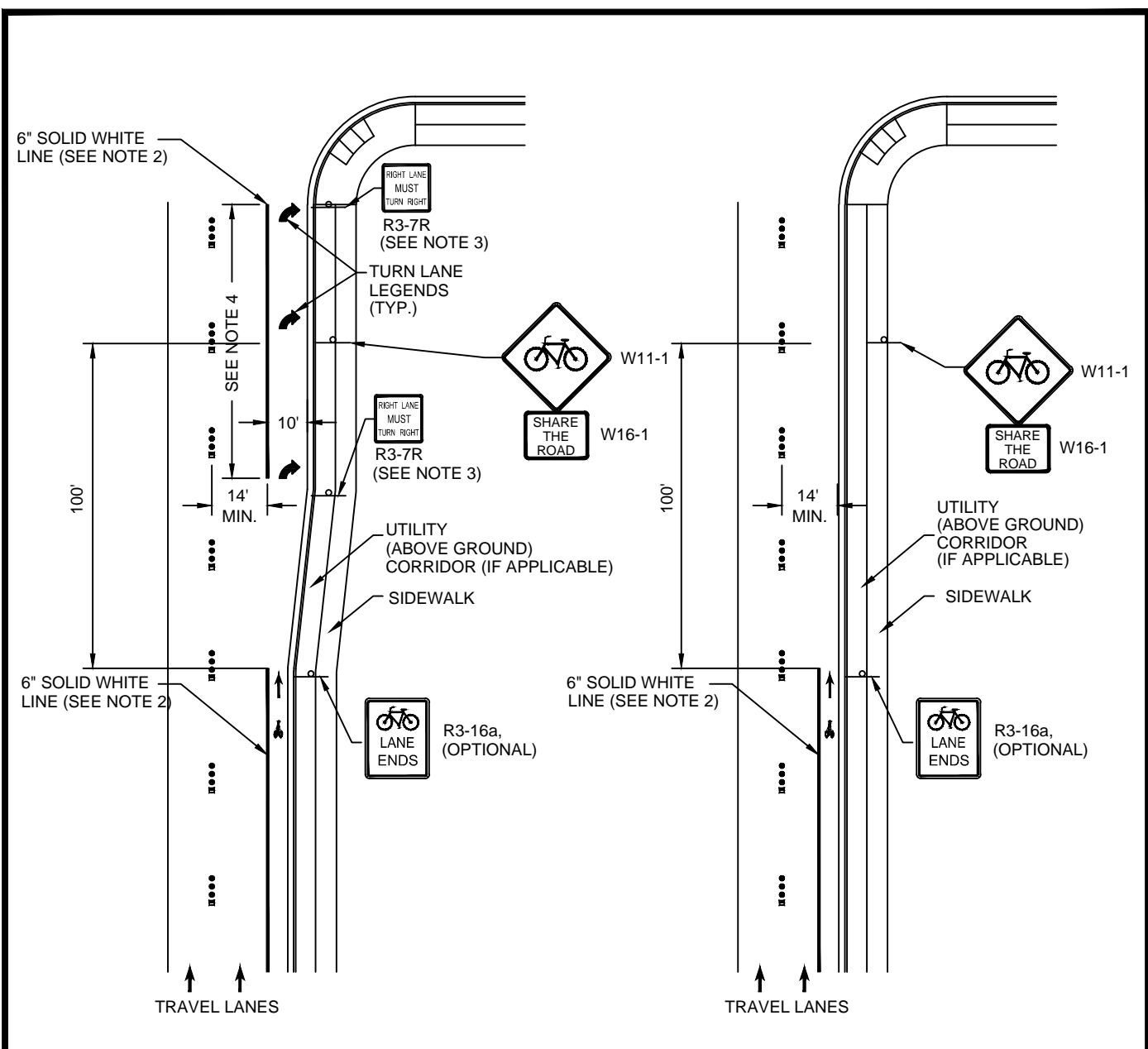

WITH EXCLUSIVE RIGHT-TURN LANE

WITHOUT EXCLUSIVE RIGHT-TURN LANE

NOTES:

1. STORAGE LENGTH TO BE DETERMINED BY TRAFFIC ENGINEER.
2. SEE DRAWING NUMBER 244.9 FOR BIKE LANE LEGEND AND SIGNAGE.
3. WHERE ADDITIONAL MOTORIST GUIDANCE IS DEEMED NECESSARY BY THE ENGINEER, INSTALL R3-7R SIGN AND ARROW SYMBOL PAVEMENT MARKINGS FOR THE LENGTH OF THE STORAGE LINE. APPROVED TYPE II PAVEMENT MARKING FILM SHALL BE USED FOR SYMBOL MARKINGS.
4. SEE DWG. 246 NOTE 1 FOR STANDARD PAVEMENT MARKERS ADDED TURN LANE.
5. THE ABOVE DETAIL SHOULD BE FOLLOWED IN SITUATIONS WHERE THERE IS NOT ADEQUATE SPACE TO PROVIDE A SEPARATE BICYCLE LANE.

		AGENCY APPROVED	B	C	H	L	M	N
SPECIFICATION REFERENCE		UNIFORM STANDARD DRAWINGS CLARK COUNTY AREA						
628	PAINTING TRAFFIC STRIPING	BICYCLE LANE TRANSITION TO SHARED LANE AT INTERSECTION						
633	PAVEMENT MARKERS							
		DATE 06-09-11	DWG. NO.		246.2			

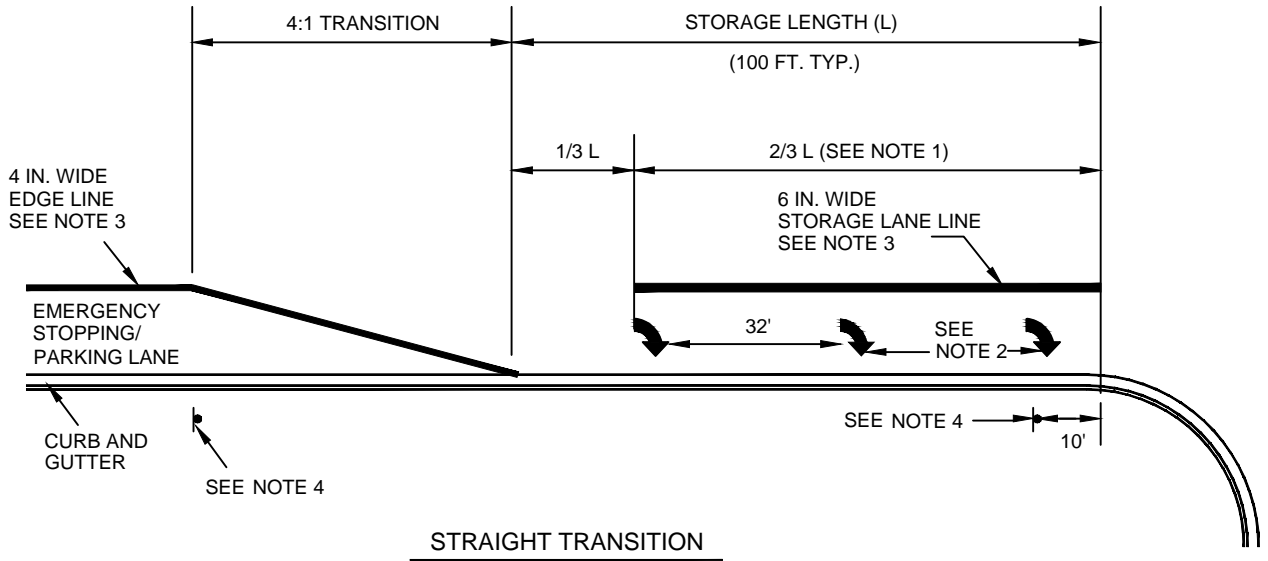
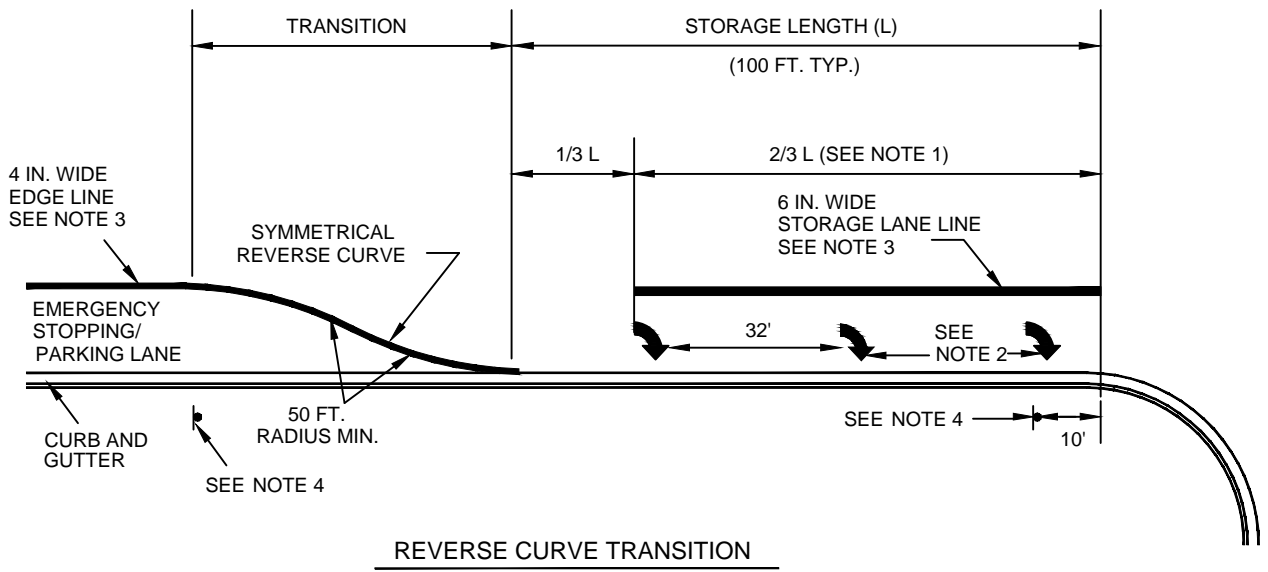

NOTES:

1. LENGTH OF STORAGE LANE LINE IS TWO THIRDS OF THE TURN LANE STORAGE LENGTH.
2. WHERE ADDITIONAL MOTORIST GUIDANCE IS DEEMED NECESSARY BY THE ENGINEER, INSTALL ARROW SYMBOL PAVEMENT MARKINGS FOR THE LENGTH OF THE STORAGE LINE.
3. PAVEMENT MARKINGS SHALL BE TYPE I TAPE OR PAINT AS DIRECTED BY THE ENGINEER.
4. INSTALL "NO PARKING" SIGNS FOR ENTIRE LENGTH OF TURN LANE. WHERE ADDITIONAL MOTORIST GUIDANCE IS DEEMED NECESSARY BY THE ENGINEER, INSTALL R3-7R SIGNS.

AGENCY APPROVED	B	C	H	L	M	N
-----------------	---	---	---	---	---	---

633	SPECIFICATION REFERENCE PAVEMENT MARKERS

UNIFORM STANDARD DRAWINGS CLARK COUNTY AREA		
PAVEMENT MARKING AND SIGNAGE RIGHT TURN LANE AT MINOR INTERSECTIONS (ARTERIALS WITH EMERGENCY/PARKING LANE)		
DATE 06-09-11	DWG. NO.	246.7

STORMWATER INLET CONCRETE STAMP

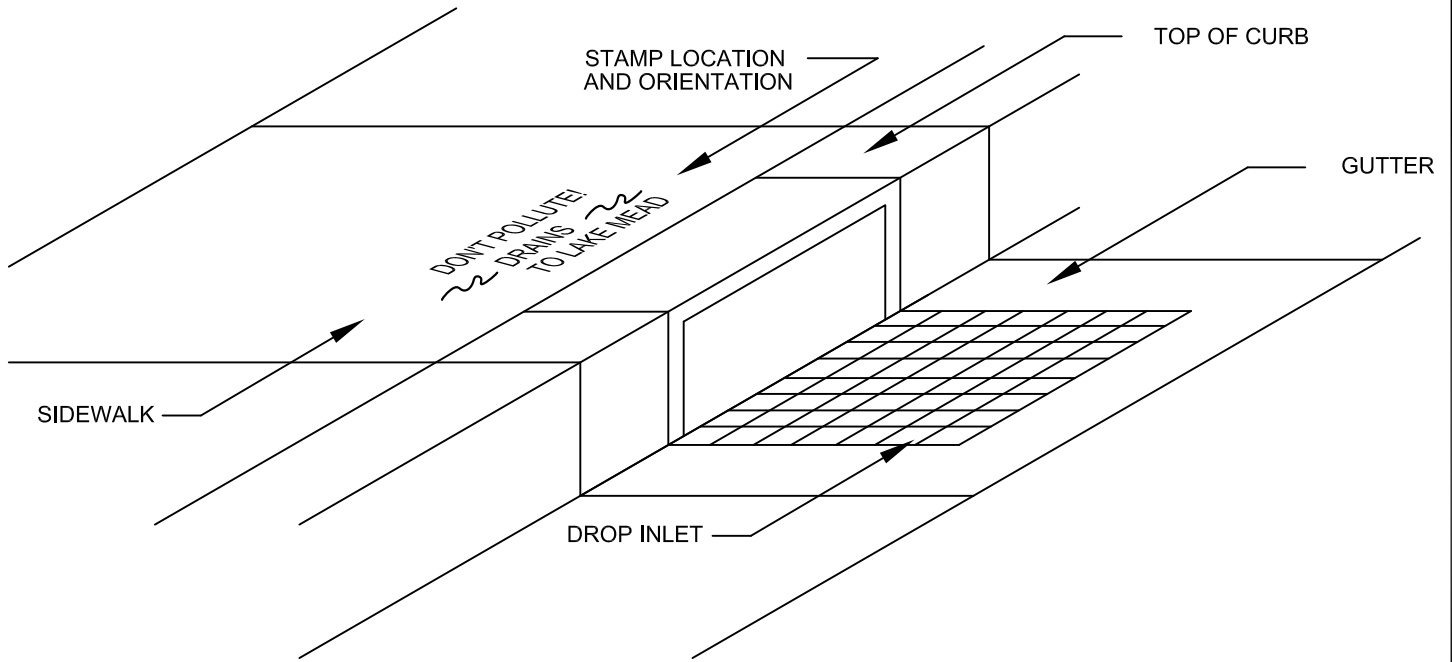

NOTES:

1. MESSAGE OR SYMBOL SHALL BE AS SHOWN ON THE DRAWING OR ON THE VERTICAL CURB NEXT TO THE DROP INLET OR AS APPROVED BY THE APPROPRIATE CITY OR COUNTY ENGINEER.
2. LETTERS SHALL BE 1-7/16" IN HEIGHT. THE MESSAGE SHALL BE CENTERED ON THE BACK OF THE INLET OR ON THE TOP OF CURB.
3. CONCRETE SHALL BE STAMPED IN SUCH A WAY AS TO PROVIDE FOR A CLEAR AND LEGIBLE IMAGE. (APPROXIMATE DEPTH OF 1/4").
4. ALL STAMPS SHALL BE APPROVED BY THE CITY OR COUNTY ENGINEER BEFORE BEING USED.
5. STAMP MAY BE PERMANENTLY CAST INTO CAST IRON FRAME OR PRE-CAST CONCRETE PORTIONS OF INLET.
6. WHERE RETROFITTING IS REQUIRED, AN EPOXIED PLACARD BEARING THE MESSAGE AND SYMBOL APPROVED BY THE APPROPRIATE CITY OR COUNTY ENGINEER SHALL BE PERMANENTLY AFFIXED ON THE TOP OF THE ADJACENT CURB.
7. THIS STANDARD IS REQUIRED IN THE LAS VEGAS VALLEY IN WHICH AREA WATER DRAINS TO LAKE MEAD.

SPECIFICATION REFERENCE		UNIFORM STANDARD DRAWINGS CLARK COUNTY AREA		
		STORM WATER QUALITY MANAGEMENT STAMP AND SIGN DETAIL		
		DATE 12-09-10	DWG. NO. 421	SHEET 1 OF 3

STAMP MESSAGES AND SYMBOLS

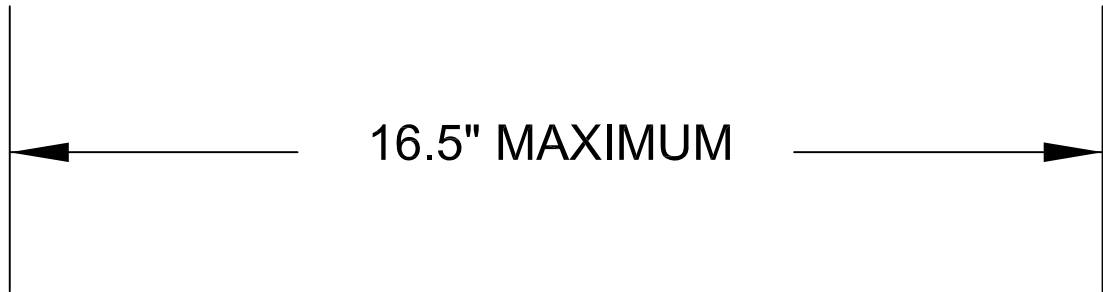

5" MAX.

DON'T POLLUTE!

~~~~~ **DRAINS** *~~~~~*

TO LAKE MEAD!

SPECIFICATION REFERENCE		UNIFORM STANDARD DRAWINGS CLARK COUNTY AREA		
		STORM WATER QUALITY MANAGEMENT STAMP AND SIGN DETAIL		
		DATE 12-09-10	DWG. NO. 421	SHEET 2 OF 3



4" PLACARD - COLORS = BLUE AND GREEN

THIS EPOXY PLACARD MESSAGE AND SYMBOL HAS BEEN APPROVED BY THE APPROPRIATE CITY OR COUNTY ENGINEER. ANY OTHER EQUIVALENT MESSAGE AND SYMBOL DESIGNS WILL REQUIRE PRIOR APPROVAL OF THE APPROPRIATE CITY OR COUNTY BEFORE INSTALLATION. THE PLACARD MATERIAL SHALL BE EITHER POLYCARBONATE OR METAL AND THE FINISH SHALL BE UV AND ABRASION RESISTANT.

STORM DRAIN MARKER

SPECIFICATION REFERENCE		UNIFORM STANDARD DRAWINGS CLARK COUNTY AREA		
		STORM WATER QUALITY MANAGEMENT STAMP AND SIGN DETAIL		
		DATE 12-09-10	DWG. NO. 421	SHEET 3 OF 3

**TYPE B - KEYHOLE REPAIR
FOR ROW WIDTH GREATER THAN 60'**

NOTES:

1. CUT AND REMOVE PAVEMENT PLUG WITH AN APPROVED KEYHOLE CORING DEVICE. PAVEMENT TO BE CORED SHALL CONTAIN NO CRACKS AND SHALL BE AT LEAST 4" THICK.
2. BONDING MATERIAL SHALL BE A SINGLE COMPONENT CEMENTITIOUS RAPID HARDENING, HIGH STRENGTH, WATERPROOF BONDING AGENT THAT ALLOWS THE CORE TO BE SUPPORTED AT LEAST TWO TIMES AASHTO H-25 LOADING WITHIN 30 MINUTES OF APPLICATION. BOND AGENT MUST SHOW A MINIMUM 20 PSI BOND STRENGTH (ASTM C882) AND A MINIMUM 200 PSI COMPRESSIVE STRENGTH (ASTM C109) IN 30 MINUTES.
3. AGENCY-APPROVED BACKFILL BELOW REPAIR SHALL BE PER SECTION 215.
4. FILL KEYHOLE WITH BONDING MATERIAL DURING REPAIR.

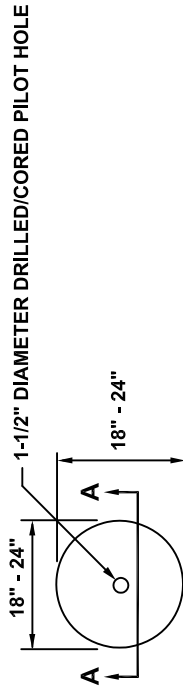

POTHOLE PLAN VIEW
(NOMINAL DIMENSIONS)

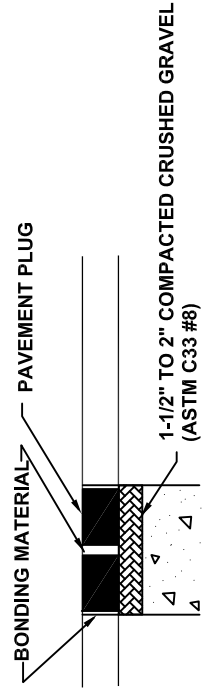

POTHOLE PROFILE

ASPHALT
VARIABLE
THICKNESS

PAVEMENT REPAIR
TYPE A OR B
FLUSH WITH EXISTING PAVEMENT

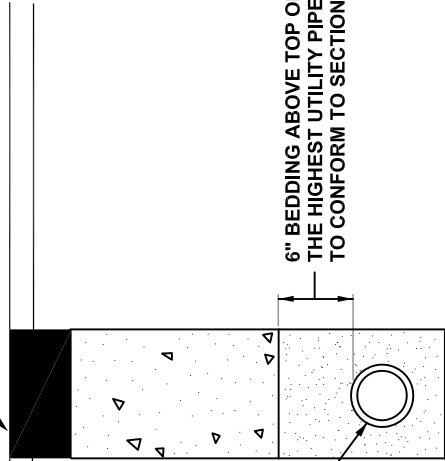

AGENCY-APPROVED MATERIAL
OR 1/2-SACK CLSM PER SEC. 728
FROM 6" ABOVE TOP OF THE
HIGHEST UTILITY TO THE
BOTTOM OF PAVEMENT REPAIR.

6" BEDDING ABOVE TOP OF
THE HIGHEST UTILITY PIPE
TO CONFORM TO SECTION 208

SECTION A-A

**TYPE A - CUT & PATCH REPAIR
FOR ROW WIDTH 60' OR LESS**

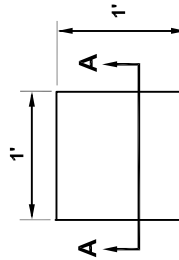

NOTE: EDGES SHALL BE CUT TO
A NEAT VERTICAL FACE.

POTHOLE PLAN VIEW
(NOMINAL DIMENSIONS)

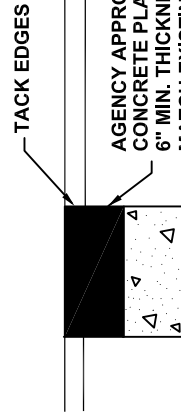

AGENCY APPROVED ASPHALT
CONCRETE PLACED IN 2" LIFTS.
6" MIN. THICKNESS OR
MATCH EXISTING.

**POTHOLE
PROFILE**

SPECIFICATION REFERENCE

UNIFORM STANDARD DRAWINGS
CLARK COUNTY AREA

UTILITY POTHOLE REPAIR

DATE 12-09-10

DWG. NO.

506

Format for Supplemental Drawings

Where a USD applies to all entities (ALL USD's)

Add new Agency Approved box attached to the title box

AGENCY APPROVED	B	C	H	L	M	N
------------------------	----------	----------	----------	----------	----------	----------

Where a USD applies to Only ONE OR MORE (BUT NOT ALL) entities

Add new block in Title Block with "SUPPLEMENTAL DRAWING"

AND

Incorporate New drawing numbering system:

301.S1 For the first Supplemental Drawing created

301.S2 For the second Supplemental Drawing created

AND

Add new Agency Approved box attached to the title box showing which entities the drawing applies to.

AGENCY APPROVED		C			M	N
------------------------	--	----------	--	--	----------	----------

Where a USD contains special notes applicable to one or more entities (but not all)

Add a pentagon symbol "⬠" in the Agency Approved box attached to the title box for entities that have a special note or exception in the drawing

AGENCY APPROVED	⬠	C	⬠	L	M	N
------------------------	---	----------	---	----------	----------	----------

VOLUME 2 MODIFICATIONS

All of the above PLUS

RE-NUMBER Volume 2 Drawings:

700 through 739 – GENERAL (Currently has 28)

740 through 759 – SCHOOL (Currently has 7)

760 through 799 – FAST-ITS (Currently has 7)

800 through 899 – TRAFFIC SIGNAL (Currently has 85)

AND

DELETE VOLUME 2 AS A SEPARATE VOLUME

Incorporate all Standard Drawings as One Set (USD)

PENTAGON SYMBOL USED TO INDICATE THAT THE NOTED AGENCY HAS A SPECIAL NOTE IN THE DRAWING

NO AGENCY LISTED IF THE DRAWING IS NOT APPROVED FOR THAT AGENCY

AGENCY APPROVED		C		L		
UNIFORM STANDARD DRAWINGS CLARK COUNTY AREA						
SUPPLEMENTAL DRAWING						
LOCAL RESIDENTIAL URBAN AREA STREET SECTIONS						
DATE	DWG. NO.	206.S1				

NEW SHEET NUMBER FOR SUPPLEMENTAL DRAWINGS

NEW SUPPLEMENTAL BLOCK USED WHEN DRAWING IS NOT APPROVED BY ALL AGENCIES

NEW ABBREVIATIONS

CITY OF NORTH LAS VEGAS

CITY OF MESQUITE

CITY OF LAS VEGAS

CITY OF HENDERSON

CLARK COUNTY

BOULDER CITY

NEW APPROVAL BLOCK
ADDED TO ALL DRAWINGS

		AGENCY APPROVED	B	C	H	L	M	N
SPECIFICATION REFERENCE		UNIFORM STANDARD DRAWINGS CLARK COUNTY AREA						
		SYMBOLS						
		DATE	DWG. NO.	101				

UNIFORM STANDARD DRAWINGS VOL I

(Summary of Revisions)

Effective 7/1/11

Drawing Number(s) (PDF)	New Drawing Number	DESCRIPTION	AGENCY APPROVAL BOX
101-104	101	Symbols	B / C / H / L / M / N /
			B / C / H / L / M / N /
			B / C / H / L / M / N /
			B / C / H / L / M / N /
105-106	105	Abbreviations	B / C / H / L / M / N /
			B / C / H / L / M / N /

SECTION 200

STREET IMPROVEMENTS

200		Pavement Structure Design Guideline Chart for Major Collector and Arterial Roadways	B / C / H / L / M / N /
200A	200.1	Pavement Structure Design Guideline Chart for Minor Collector and Residential Roadways	B / C / H / L / M / N /
201		Minimum Back of Curb Radius	B / C / H / L / M / N /
201.1		Additional Right-of-Way Required at Major Intersections	B / C / H / L / M / N /
201.2		Sight Visibility Zones at Intersections	B / C / H / L / M / N /
202		Arterial Urban Area Street Sections With Curbside Sidewalk	B / C* / H / L / M / N /
202 ALT	203	Arterial Alternate Urban Area Street Sections With Offset Sidewalk	B / C / H / L / M / N /
205		Collector Urban Area Street Sections With Curbside Sidewalk	B* / C* / H* / L / M* / N /
205 ALT	205.1.S1	Collector Alternate Urban Area Street Sections With Offset Sidewalk (Clark County, Las Vegas and North Las Vegas)	/ C* / / L / / N /
206	206.S2	Local Residential Urban Area Street Section (Henderson, Boulder City, Mesquite)	B* / / H / / M* / /
207	206.S1	Local Residential Urban Area Street Sections (Clark County, Las Vegas and North Las Vegas)	/ C / / L / / N* /
208		Half Street Construction Sections	B / C / H / L / M / N /
208.1	IDELETE!	Half Street Construction Sections (Clark County Only)	
209		Access Roads (For Use in Hydrographic Basin No. 212) (PM-10 Non-Attainment Areas)	B / C / H / L / M / N /
209A	209.1	Access Road (For Use in PM-10 Compliant Areas)	B / C / H / L / M / N /
210		Private Street Sections	B / C / H / L / M / N* /
211		Knuckle	B / C / H / L / M / N /
211.1	211.1.S1	Knuckle - Type 1 (Clark County Only)	/ C / / / / /
212		Cul-De-Sac	B* / C* / H* / L* / M* / N* /
213	212.1.S1	Hammerhead (Clark County Only)	/ C / / / / /
214	214.S1	Alley (Except Clark County)	B / / H / L / M / N /
215	215.S1	Alley, Concrete (Except Clark County)	B / / H / L / M / N /
216		"L" Type Curb and Gutter	B / C / H / L / M / N /
217A	217.S1	30" Roll Curb Residential Area (Clark County, Las Vegas, North Las Vegas and Henderson Only)	/ C / H / L* / / N* /
218		Median Island Typical Section	B / C / H* / L / M / N /
219		"A" and "L" Type Island Curb	B / C / H / L / M / N /

UNIFORM STANDARD DRAWINGS VOL I

(Summary of Revisions)

Effective 7/1/11

Drawing Number(s) (PDF)	New Drawing Number	DESCRIPTION	AGENCY APPROVAL BOX
220		Tack on Island Curb	B / C / H / L / M / N /
221	220.1.S1	Tack on Island (Except City of Henderson)	B / C / / L / M / N /
221.1	221	Channelized Median Detail for Commercial Driveways or Intersecting Streets	B / C / H* / L / M / N /
222		Residential Driveway Geometrics	B / C* / H / L / M / N* /
222A	222.1	Commercial and Multi-Family Driveway Geometrics	B / C / H / L / M / N /
		Commercial and Multi-Family Security Gate Geometrics	B / C / H / L / M / N /
223		Residential Driveway	B / C / H / L / M / N /
224		Commercial and Industrial Driveway (Option A)	B / C / H / L / M / N /
225		Commercial and Industrial Driveway (Option B) or Private Street Access	B / C / H / L / M / N /
226	226.S1	Commercial and Industrial Driveway (Option C) (Allowable in North Las Vegas Only)	/ / / / / N /
226.1	226.S2	Light Duty Commercial Driveway (Offices, Churches, Schools, Restaurants, etc.) (Henderson Only)	/ / H / / / /
226.2	226.S3	Heavy-Duty Commercial Driveway (Service Stations, Industrial, Loading Docks, etc.) (City of Henderson Only)	/ / H / / / /
227	227.S1	Depressed Alley Driveway (City of Las Vegas Only)	/ / / L / / /
228		Cross Gutter	B / C / H / L / M / N /
229		Half Street Cross Gutter	B / C / H / L / M / N /
230		Concrete Pavement Intersection Typical Layout	B / C / H / L / M / N /
231		Concrete Pavement Typical Roadway Section	B / C / H / L / M / N /
232		Concrete Pavement Construction Details	B / C / H / L / M / N /
233		Concrete Pavement Joint Details	B / C / H / L / M / N /
234		Sidewalk	B / C / H / L / M / N /
234.1		Typical Bus Turn-Out	B / C / H / L / M / N /
234.2		Typical Bus Stop Passenger Loading and Shelter Pads	B / C / H / L / M / N /
234.2A	234.3	Typical Double Bus Stop Passenger Loading and Shelter Pads	B / C / H / L / M / N /
234.3	234.4	Bus Stop Placement Within Exclusive Right Turn Lane for Commercial Properties	B / C / H / L / M / N /
235		Sidewalk Ramp (Case I)	B* / C / H / L / M / N /
		Sidewalk Ramp (Case II)	B* / C / H / L / M / N /
		Sidewalk Ramp (Case III)	B* / C / H / L / M / N /
		Sidewalk Ramp Details	B / C / H / L / M / N /
235.1		Sidewalk Ramp Location "T" Intersections	B / C / H / L / M / N /
236		Sidewalk Drain	B / C / H / L / M / N /
237		Concrete Barrier Rail	B / C / H / L / M / N /
238		Precast Bumper Block	B / C / H / L / M / N /
239		Type I Monument	B / C / H / L / M / N /
240		Type II Monument	B / C / H / L / M / N /
241		Type III Monument	B / C / H / L / M / N /

UNIFORM STANDARD DRAWINGS VOL I

(Summary of Revisions)

Effective 7/1/11

Drawing Number(s) (PDF)	New Drawing Number	DESCRIPTION	AGENCY APPROVAL BOX
242		Type IV Monument	B / C / H / L / M / N /
243		Typical Monument Location	B / C / H / L / M / N /
244		Typical Centerline Delineation	B / C / H / L / M / N /
244A	244.1	Typical Lane Line Delineation	B / C / H / L / M / N /
244.1	244.2	Typical Delineation for Roadways 100 Ft. or Greater Right-of-Way With Curbside Sidewalk	B / C / H / L / M / N /
244.1 ALT	244.3	Typical Delineation for Alternate Roadways With Offset Sidewalk	B / C / H / L / M / N /
244.1A	244.4	Typical Delineation for Roadways 100 Ft. Right-of-Way With Curbside Sidewalk	B / C / H / L / M / N /
244.2	244.5	Typical Delineation for Roadways 80 Ft. Right-of-Way With Curbside Sidewalk	B / C / H / L / M / N /
244.2A		Typical Delineation for Roadways 80 Ft. Right-of-Way With Curbside Sidewalk	B / C / H / L / M / N /
244.3	244.7	Typical Delineation for Bike Facilities 60 Ft. Right-of-Way (Parking on Both Sides)	B / C / H / L / M / N /
244.4	244.8	Bicycle Lane Delineation on One-Way Street	B / C / H / L / M / N /
244.5	244.9	Bicycle Lane Delineation, Legend, and Signage	B / C / H / L / M / N /
245		Typical Lane Delineation in Transition Sections	B / C / H / L / M / N /
		Details for Typical Lane Delineation in Transition Sections	B / C / H / L / M / N /
		Typical Lane Delineation in Transition Sections Where Traffic Flow in Same Direction	B / C / H / L / M / N /
245.1		Typical Lane Configuration for Major Street Intersections and Median Detail	B / C / H / L / M / N /
		Case I - With Curbside Sidewalk Case II - With Curbside Sidewalk	B / C / H / L / M / N /
245.1 ALT	245.2	Typical Lane Configuration for Major Street Intersections and Median Detail	B / C / H / L / M / N /
		Case I - With Offset Sidewalk	B / C / H / L / M / N /
		Case II - With Offset Sidewalk	B / C / H / L / M / N /
246		Standard Pavement Markers Added Turn Lane	B / C / H / L / M / N /
246A	246.6	Standard Pavement Markers Forced Turn Lane	B / C / H / L / M / N /
246B	246.7	Pavement Marking and Signage Right Turn Lane at Minor Intersections (Arterials With Emergency/Parking Lane)	B / C / H / L / M / N /
246.1		Bike Lane Approach to Intersection With Exclusive Right Turn Lane	B / C / H / L / M / N /
246.2		Bicycle Lane Transition to Shared Lane at Intersection	B / C / H / L / M / N /
246.3		Bicycle Lane at a Right Turn Drop Lane	B / C / H / L / M / N /
246.4		Bicycle Lane Delineation at Approach to Intersection Without Exclusive Right-Turn Lane	B / C / H / L / M / N /
246.5		Bicycle Lane Departure From Intersections	B / C / H / L / M / N /
247		Marker Details and Lane Marker Schedule	B / C / H / L / M / N /
248		Median Nose Markings	B / C / H / L / M / N /
249		Standard Street Name Sign Post Installation	B / C / H / L / M* / N /

UNIFORM STANDARD DRAWINGS VOL I

(Summary of Revisions)

Effective 7/1/11

Drawing Number(s) (PDF)	New Drawing Number	DESCRIPTION	AGENCY APPROVAL BOX
249A	249.1	Sign Installation Detail	B / C / H / L / M / N /
250		Street Name Signs Face Copy	B / C / H / L / M / N* /
		Street Name Signs Letter Spacing	B / C / H / L / M / N /
251		Street Name Sign Blanks	B / C / H / L / M / N /
252		Chain Link Fence (72" High or Less)	B / C / H / L / M / N /
253		Chain Link Gates	B / C / H / L / M / N /
254	254.1.S1	Crosswalk Markings - Type II (Except Clark County)	B / / H / L / M / N /
254A	254	Crosswalk Markings - Type I	B / C / H / L / M / N /
255		Shared Use Path	B / C / H / L / M / N /
255.1		Shared Use Path Along a Roadway	B / C / H / L / M / N /
255.2		Typical Transition Section From Shared Use Path Along Roadway to Sidewalk	B / C / H / L / M / N /
255.3		Sign Sizes for Shared Use Path	B / C / H / L / M / N /
255.4		Delineation and Bollard Usage on Shared Use Path	B / C / H / L / M / N /
256		Shared Use Path Crossing of Free Right Turn Lane	B / C / H / L / M / N /
256.1		Typical Signage for Shared Use Path at Intersection	B / C / H / L / M / N /
256.2		Shared Use Path Crossing Two Lane Roadway	B / C / H / L / M / N /
256.3		Shared Use Path Crossing 4 Lane Roadway	B / C / H / L / M / N /
256.4		Shared Use Path Crossing 6 Lane Roadway	B / C / H / L / M / N /
256.5		Shared Use Path Under Crossing	B / C / H / L / M / N /
256.6		Shared Use Path Crossing Railroad	B / C / H / L / M / N /
256.7		Typical Delineation for Shared Use Path Parallel to Railroad Crossing a Roadway	B / C / H / L / M / N /

UNIFORM STANDARD DRAWINGS VOL I

(Summary of Revisions)

Effective 7/1/11

Drawing Number(s) (PDF)	New Drawing Number	DESCRIPTION	AGENCY APPROVAL BOX
SECTION 300			
STREET LIGHTING			
300		Streetlight Locations General Notes	B / C* / H* / L / M / N /
301	301.S1	Streetlight Locations at Intersections 100' or Greater/100' or Greater Right-of-Way (Except Clark County)	B* / / H* / L / M / N /
301.1	301.S2	Streetlight Locations at Intersections 100' or Greater/100' or Greater Right-of-Way (Clark County Only)	/ C / / / / /
302	302.S1	Streetlight Locations at Intersections 100' or Greater/80' Right-of-Way (Except Clark County)	B* / / H* / L / M / N /
302.1	302.S2	Streetlight Locations at Intersections 100' or Greater/80' Right-of-Way (Clark County Only)	/ C / / / / /
303	303.S1	Streetlight Locations at Intersections 100' or Greater/60' Right-of-Way (Except Clark County & Henderson)	B* / / / L / M / N /
303.1	303.S2	Streetlight Locations at Intersections 100' or Greater/60' Right-of-Way (Clark County & Henderson Only)	/ C* / H* / / / /
304	304.S1	Streetlight Locations at Intersections 100' or Greater/51' or Less Right-of-Way (Except Clark County & Henderson)	B* / / / L / M / N /
304.1	304.S2	Streetlight Locations at Intersections 100' or Greater/51' or Less Right-of-Way (Clark County & Henderson Only)	/ C* / H* / / / /
305	305.S1	Streetlight Locations at Intersections 80'/80' Right-of-Way (Except Clark County)	B / / H / L / M / N /
305.1	305.S2	Streetlight Locations at Intersections 80'/80' Right-of-Way (Clark County Only)	/ C / / / / /
306	306.S1	Streetlight Locations at Intersections 80'/60' Right-of-Way (Except Clark County & Henderson)	B / / / L / M / N /
306.1	306.S2	Streetlight Locations at Intersections 80'/60' Right-of-Way (Clark County & Henderson Only)	/ C / H / / / /
307	307.S1	Streetlight Locations at Intersections 80'/51' or Less Right-of-Way (Except Clark County & Henderson)	B / / / L / M / N /
307.1	307.S2	Streetlight Locations at Intersections 80'/51' or Less Right-of-Way (Clark County & Henderson Only)	/ C / H / / / /
308	308.S1	Streetlight Locations at Intersections 60'/60' Right-of-Way (Except Clark County & Henderson)	B / / / L / M / N /
308.1	308.S2	Streetlight Locations at Intersections 60'/60' Right-of-Way (Clark County & Henderson Only)	/ C / H / / / /
309	309.S1	Streetlight Locations at Intersections 60'/51' or Less Right-of-Way (Except Clark County & Henderson)	B / / / L / M / N /
309.1	309.S2	Streetlight Locations at Intersections 60'/51' or Less Right-of-Way (Clark County & Henderson Only)	/ C / H / / / /
310		Streetlight Locations at Intersections 51' or Less/51' or Less Right-of-Way	B / C / H / L / M / N /
311	311.S1	Streetlight Standards Maximum Spacing (80 Ft. or Greater Right-of-Way) (Except Clark County)	B / / H / L / M / N /

UNIFORM STANDARD DRAWINGS VOL I

(Summary of Revisions)

Effective 7/1/11

Drawing Number(s) (PDF)	New Drawing Number	DESCRIPTION	AGENCY APPROVAL BOX
311.1	311.S2	Streetlight Standards Maximum Spacing (80 Ft. or Greater Right-of-Way) (Clark County Only)	/ C / / / / /
311A	311.1.S1	Streetlight Standards Maximum Spacing (60 Ft. or Less Right-of-Way) (Except Clark County & Henderson)	B / / / L / M / N /
311.1A	311.1.S2	Streetlight Standards Maximum Spacing (60 Ft. or Less Right-of-Way) (Clark County & Henderson Only)	/ C / H / / / /
312		Streetlight Locations on Traffic Islands 100' or Greater Right-of-Way	B / C * / H / L / M / N /
313		Streetlight Standard General Notes	B / C / H / L / M / N /
314		Streetlight Standard With 2" Pipe Arm	B / C / H / L / M / N /
315		Streetlight Standard With Double 2" Pipe Arm	B / C / H / L / M / N /
316		Streetlight Standard With Tapered Mast Arm	B / C / H / L / M / N /
317		Streetlight Standard With Double Tapered Mast Arm	B / C / H / L / M / N /
318		Pole Top and Arm Mounting Details	B / C / H / L / M / N /
319		Lower Pole Details for Pipe and Mast Arm Poles	B / C / H / L / M / N /
320		Lighting Standard Setback	B / C / H / L / M / N /
320A	320.1	Lighting Standard Setback From Block Wall	B / C / H / L / M / N /
321		Lighting Standard Foundation	B / C / H / L / M / N /
322		Base Adaptor Plate for 16-1/2" Bolt Circle Foundation	B / C / H / L / M / N /
322A	322.1	Base Adaptor Plate for 19" Bolt Circle Foundation	B / C / H / L / M / N /
323		Pull Box Cover Bonding Detail	B / C * / H / L / M / N /
324	324.S1	Bypass Switch Bracket for Pole Mounted Streetlight Service (City of Mesquite Only)	/ / / / M / /
325	321.1.S1	Modified Existing Streetlight Foundation for Installation of Underground Conduit (City of Las Vegas and Clark County Only)	/ C / / L / / /
326		Precast Reinforced Concrete Pull Box	B / C / H / L / M / N /
327		Pull Box Street Cover	B / C / H / L / M / N /
328		Utility Pull Box Locations Sidewalk and Between Driveways	B / C / H / L / M / N /
329		Concrete Around Pull Boxes in Undeveloped Areas	B / C / H / L / M / N /
330	DELETED See #730	Single Meter Service Pedestal	B / C / H / L / M / N /
331		Service Pedestal Setback	B / C / H / L / M / N /
332	332.S1	Service Pedestal Foundation (Except Clark County and City of Las Vegas)	B / / H / / M / N /
332.1	332.S2	Service Pedestal Foundation (Clark County and City of Las Vegas)	/ C * / / L * / / /
333	333.S1	Streetlighting Service Point Located on a Streetlight Standard (City of Mesquite Only)	/ / / / M / /
334		Temporary Application 120/240 VAC Service on Wood Pole Overhead Service	B / C / H / L / M / N /
335	335.S1	Streetlight Circuit One Line Diagram (Except Clark County and City of Las Vegas)	B / / H / / M / N /
335.1	335.S2	Streetlight Circuit One Line Diagram (Clark County and City of Las Vegas)	/ C / / L / / /

UNIFORM STANDARD DRAWINGS VOL I

(Summary of Revisions)

Effective 7/1/11

Drawing Number(s) (PDF)	New Drawing Number	DESCRIPTION	AGENCY APPROVAL BOX
336		System Grounding Plan With Pedestal Service	B / C / H / L / M / N /
337		System Grounding Plan With Pole Mounted Service	B / C / H / L / M / N /
338		Lighting Standard Wiring Diagram, 240 Volt, 2 Wire	B / C / H / L / M / N /
339		Twin Lighting Standard Wiring Diagram, 240 Volt, 2 Wire	B / C / H / L / M / N /
340		Lighting Standard Wiring Diagram, 120 Volt, 1 Phase, 3 Wire	B / C / H / L / M / N /

SECTION 400

DRAINAGE IMPROVEMENTS

401		Storm Drain Manholes General Notes	B / C / H / L / M / N / B / C / H / L / M / N /
402		Storm Drain Drop Inlet General Notes	B / C / H / L / M / N /
403		Type I Manhole	B / C / H / L / M / N /
403A	403.1	Type I Manhole 30" Ring and Cover	B / C / H / L / M / N /
404		Type IA Manhole	B / C / H / L / M / N /
404A	404.1	Type IA Manhole 30" Ring and Cover	B / C / H / L / M / N /
405		Type II Manhole	B / C / H / L / M / N /
405A	405.1	Type II Manhole 30" Ring and Cover	B / C / H / L / M / N /
406		Type III Manhole	B / C / H / L / M / N /
406A	406.1	Type III Manhole 30" Ring and Cover	B / C / H / L / M / N /
407		Precast Manhole Tees	B / C / H / L / M / N /
407A	407.1	Precast Manhole Tees 30" Ring and Cover	B / C / H / L / M / N /
408		Concrete Collar Around Manholes	B / C* / H / L / M / N /
408A	408.1	Concrete Collar Around Manholes 30" Ring and Cover	B / C* / H / L / M / N /
409		Standard Manhole Cover and Ring	B / C / H / L / M / N /
409A	409.1	Standard Manhole 30" Cover and Ring	B / C / H / L / M / N /
410		Standard Manhole Steps	B / C / H / L / M / N /
411		Drop Inlet Type "A"	B / C / H / L / M / N /
411A	411.1	Modified Type "A" Drop Inlet	B / C / H / L / M / N /
412		Drop Inlet Type "B"	B / C / H / L / M / N /
412A	412.1	Type "C-D" Modified Drop Inlet	B / C / H / L / M / N /
413		Drop Inlet Type "C"	B / C / H / L / M / N /
414		Drop Inlet Type "D"	B / C / H / L / M / N /
415		Drop Inlet Type "A" and "B" Special Design	B / C / H / L / M / N /
416		Beehive Drop Inlet	B / C / H / L / M / N /
417		Drop Inlet Frame and Grate	B / C / H / L / M / N /
418		Drop Inlet Steel Plate Anchorage	B / C / H / L / M / N /
419		Drop Inlet Steel Plate and Protection Bar	B / C / H / L / M / N /

UNIFORM STANDARD DRAWINGS VOL I

(Summary of Revisions)

Effective 7/1/11

Drawing Number(s) (PDF)	New Drawing Number	DESCRIPTION	AGENCY APPROVAL BOX
420		Typical Open Channel	B / C / H / L / M / N /
421		Storm Water Quality Management Stamp and Sign Detail	B / C / H / L / M / N /

SECTION 500

UTILITIES AND MISCELLANEOUS IMPROVEMENTS

500AL	500.1	0 To 5 Years Pavement Restoration Longitudinal Cut	B / C / H / L / M / N / B / C / H / L / M / N /
500AT	500.2	0 To 5 Years Pavement Restoration Transverse Cut	B / C / H / L / M / N /
500BL1	500.3	Over 5 Years Pavement Restoration Longitudinal Cut – Greater Than 60'R/W	B / C / H / L / M / N /
500BL2	500.4	Over 5 Years Pavement Restoration Longitudinal Cut – 60'R/W or Less	B / C / H / L / M / N /
500BT	500.5	Over 5 Years Pavement Restoration Transverse All R/W Widths	B / C / H / L / M / N /
501		Typical Underground Utility Locations in Residential Streets With 60 Feet or Less Right-of-Way	B / C / H / L / M / N /
501A	501.1	Typical Underground Utility Locations in Streets With Greater Than 60 Feet Right-of-Way	B / C / H / L / M / N /
503B	503	Method B for Rigid and Flexible Pipe Trench Backfill - Paved Areas	B / C / H / L / M / N /
503AF	503.1	Method A for Flexible Pipe Trench Backfill-Paved Areas	B / C / H / L / M / N /
503AR	503.2	Method A for Rigid Pipe Trench Backfill – Paved Areas	B / C / H / L / M / N /
505		Pipe Trench Bedding Methods	B / C / H / L / M / N /
506		Utility Pothole Repair	B / C / H / L / M / N /

SECTION 600

TRAFFIC CONTROL PLANS FOR HIGHWAY WORK ZONE

(Note: All 600 Series Drawings are 11 X 17)

601		Typical Application for Barricades & Flagger Traffic Control Sign Standard Designs	B / C / H / L / M / N / B / C / H / L / M / N /
602		Warranting Conditions for Portable Concrete Barrier Rail	B / C / H / L / M / N / B / C / H / L / M / N /
603		Typical Application for Short Time, Day or Night Operations	B / C / H / L / M / N /
604		Typical Application for Rural Moving Day Operations Where Activities Encroach on the Shoulder	B / C / H / L / M / N /
605		Typical Application for Rural Moving Day Operations Where Activities Encroach on the Pavement	B / C / H / L / M / N /
606		Typical Application for 2-Lane, 2-Way Rural Day or Night Operations Where Activities are More Than 15 Ft. From Edge of Pavement	B / C / H / L / M / N /
607		Typical Application for 2-Lane, 2-Way Rural Day or Night Operations Where Activities Will Encroach Between 15 Ft. & 2 Ft. Outside of Pavement Edge	B / C / H / L / M / N /
608		Typical Application for 2-Lane, 2-Way Rural Day Operations Where Activities Will Encroach Between Centerline and 2 Ft. Outside of Pavement Edge	B / C / H / L / M / N /
609		Typical Application for 2-Lane, 2-Way Rural Night Operations Where Activities Will Encroach Between Centerline & 2 Ft. Outside of Pavement Edge	B / C / H / L / M / N /

UNIFORM STANDARD DRAWINGS VOL I

(Summary of Revisions)

Effective 7/1/11

Drawing Number(s) (PDF)	New Drawing Number	DESCRIPTION	AGENCY APPROVAL BOX
610		Typical Application for 2-Lane, 2-Way Rural Day or Night Operations Where Activities Will Encroach Between Centerline & 2 Ft. Outside of Pavement Edge	B / C / H / L / M / N /
611		Typical Application for 2-Lane, 2-Way, Rural or Suburban, Day or Night Pavement Widening	B / C / H / L / M / N /
612		Typical Application for 2-Lane, 2-Way, Rural or Suburban, Day or Night Temporary <u>Paved</u> Bypass	B / C / H / L / M / N /
		Typical Application for 2-Lane, 2-Way, Rural or Suburban, Day or Night Temporary <u>Unpaved</u> Bypass	B / C / H / L / M / N /
613		Typical Application for 2-Lane, 2-Way Rural Day or Night Operations With One Lane Closed	B / C / H / L / M / N /
614		Typical Application for Multilane, Divided or Undivided, Rural or Suburban, Day or Night Operations Where Activities Are More Than 15 Ft. From Edge of Pavement	B / C / H / L / M / N /
615		Typical Application for Multilane, Divided or Undivided, Rural or Suburban, Day or Night Operations Where Activities Will Encroach Between 15 Ft. & 2 Ft. Outside Pavement Edge	B / C / H / L / M / N /
616		Typical Application for Multilane, Divided, Rural or Suburban, Day Operations Where Operation Moves Between 1 and 15 MPH	B / C / H / L / M / N /
617		Typical Application for Multilane, Divided or Undivided, Rural or Suburban, Day Operations Where Activities Will Encroach on Lane Abutting Shoulder or on the Shoulder Within 2 Ft. Outside the Pavement Edge	B / C / H / L / M / N /
618		Typical Application for Multilane, Divided or Undivided, Rural or Suburban, Day and Night Operations Where Activities Will Encroach on Lane Abutting Shoulder or on the Shoulder Within 2 Ft. Outside of Pavement Edge	B / C / H / L / M / N /
619		Typical Application for Multilane, Undivided, Rural or Suburban, Day/Night Operations With a Work Area in the Left Lane, Allowing Work Access from Adjacent Lane	B / C / H / L / M / N /
620		Typical Application for Multilane, 1-Way or Divided, Rural or Suburban, Day/Night Operations Where Center Lane(s) Are Closed	B / C / H / L / M / N /
621		Typical Application for Multilane, Divided, Rural or Suburban, Day or Night Where Activities Require Closing 2 Adjacent Lanes & an Opposing Lane is Used for a Temporary Crossover	B / C / H / L / M / N /
622		Typical Application for Work Areas Within or Near Suburban Intersections	B / C / H / L / M / N /
623		Typical Application for 2-Lane, 2-Way, Rural or Suburban, Day or Night Road Closure	B / C / H / L / M / N /
624		Typical Application for Controlling Pedestrian Traffic	B / C / H / L / M / N /
625		Typical Application for Slow Moving or Short Duration Stopping <u>in</u> a Marked Travel Lane on Non-Local Streets	B / C / H / L / M / N /
626		Typical Application for Placement of "No Parking" Signs for Short-Term Street Rehabilitation Projects	B / C / H / L / M / N /
627		Typical Application for Standard for "Speeding Penalties Doubled" Sign for Use in Temporary Traffic Control Zones	B / C / H / L / M / N /

UNIFORM STANDARD DRAWINGS VOL II

(Summary of Revisions)

Effective 7/1/11

Drawing Number(s) (PDF)		DESCRIPTION	AGENCY APPROVAL BOX
404.001	701	Standard Symbols for Traffic Signal Drawings	B / C / H / L / M / N / B / C / H / L / M / N /
404.002	702	Quadrant Detail	B / C / H / L / M / N /

PULL BOXES

404.110	705	No. 3-1/2 Pull Box	B / C / H / L / M / N /
404.120	706	No. 5 Pull Box	B / C / H / L / M / N /
404.121	706.1	Reinforced Plastic Mortar Service Box Assembly #5	B / C / H / L / M / N /
404.130	707	No. 7 Pull Box	B / C / H / L / M / N /
404.131	707.1	Reinforced Plastic Mortar Service Box Assembly #7	B / C / H / L / M / N /
404.132	761	"P30" Pullbox (For Use in Interconnect and Communications Installations)	B / C / H / L / M / N /
404.133	762	Type 200 Vault (For Use at Fiber Optic Splice Points)	B / C / H / L / M / N /
404.139	708	Steel Pull Boxes	B / C / H / L / M / N /
404.140	709	Pull Box Street Cover	B / C / H / L / M / N /
		Pull Box Cover Bonding Detail	B / C* / H / L / M / N /
404.141	710	Pull Box Foundation	B / C / H / L / M / N /
404.142	763	ITS Communication Conduit and Pull Box Detail (For Existing Curb & Gutter)	B / C / H / L / M / N /
404.143	711	Pull Box Concrete Collar in Undeveloped Areas	B / C / H / L / M / N /
404.144	764	ITS Communication Conduit and Pull Box Detail Installed Under New Sidewalk	B / C / H / L / M / N /

FOUNDATIONS

404.201	715	Type "A" Foundation	B / C / H / L / M / N /
404.202	716	Type "B" Foundation	B / C / H / L / M / N /
404.203	717	Type "C" Foundation	B / C / H / L / M / N /
404.205	718	Type "E" Foundation	B / C / H / L / M / N /
404.206	719	Type "F" Foundation	B / C / H / L / M / N /
404.207	720	Type "G" Foundation	B / C / H / L / M / N /
404.208	721	Type "H" Foundation	B / C / H / L / M / N /
404.209	722	Type "L" Foundation	B / C / H / L / M / N /
404.210	723	Type "M" Foundation	B / C / H / L / M / N /
404.211	724	Type "I" Foundation	B / C / H / L / M / N /
404.213	725	Type "J" & "K" Foundations	B / C / H / L / M / N /
404.213A	725.1	Cabinet Conduit Layout Type "J" and "K" Foundations	B / C / H / L / M / N /
404.214	726	Service Pedestal Foundation	B / C / H / L / M / N /

CABINET

404.304	801	Type V Cabinet	B / C / H / L / M / N /
404.305	802	Type VI Cabinet	B / C / H / L / M / N /